

**W 7th St**

Install approx. 2040' of 6" main by directional bore on W 7th St.  
Renew or transfer 6 services.

Design: 559113      Location: W 7th St  
WO: 12480512      City: Saint Paul  
Date: 5/3/2017      T:28N R: 23W S: 21,22

Designer: Jeff McGraw  
Email: jeffrey.s.mcgraw@xcelenergy.com  
Phone: (651) 229-2379

I hereby certify that this plan, specification or report was prepared by me or under my direct supervision and that I am a duly Licensed Professional Engineer under the laws of the State of Minnesota.

Date: \_\_\_\_\_ License: \_\_\_\_\_

- |                     |                       |
|---------------------|-----------------------|
| — New Gas Main      | ■ Building Footprints |
| — Sanitary Sewer    | □ Parcels             |
| — Storm Sewer       | ○ Trees               |
| — Water             | ■ Sidewalk            |
| — UG Electric       | ● Streetlights        |
| — Retired Gas Main  | ■ Catch Basin         |
| — Existing Gas Main |                       |
| — Streetlighting    |                       |

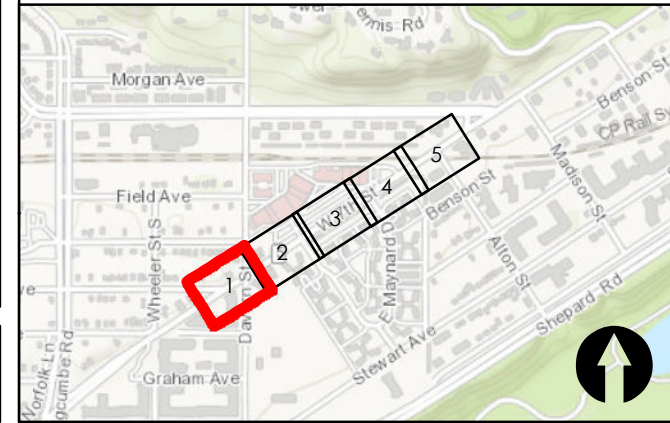

THE SUBSURFACE UTILITY INFORMATION IN THIS PLAN IS UTILITY QUALITY LEVEL D. THIS QUALITY LEVEL WAS DETERMINED ACCORDING TO THE GUIDELINES OF CI/ASCE 38.-2, ENTITLED "STANDARD GUIDELINES FOR THE COLLECTION AND DEPICTION OF EXISTING SUBSURFACE UTILITY DATA".  
DISCLAIMER: STATE LAW REQUIRES ANYONE DIGGING, GRADING, OR EXCAVATING TO OBTAIN A PRIOR FIELD LOCATE OF ALL UTILITIES; THIS PRINT DOES NOT DISCHARGE THIS REQUIREMENT OR ANY OTHER REQUIREMENT. BY ACCEPTING THIS PRINT, THE RECIPIENT AND OTHER PARTY RECEIVING A COPY OF THE PRINT ACKNOWLEDGES AND AGREES TO THIS DISCLAIMER. FOR ALL FIELD LOCATES, CALL 811.

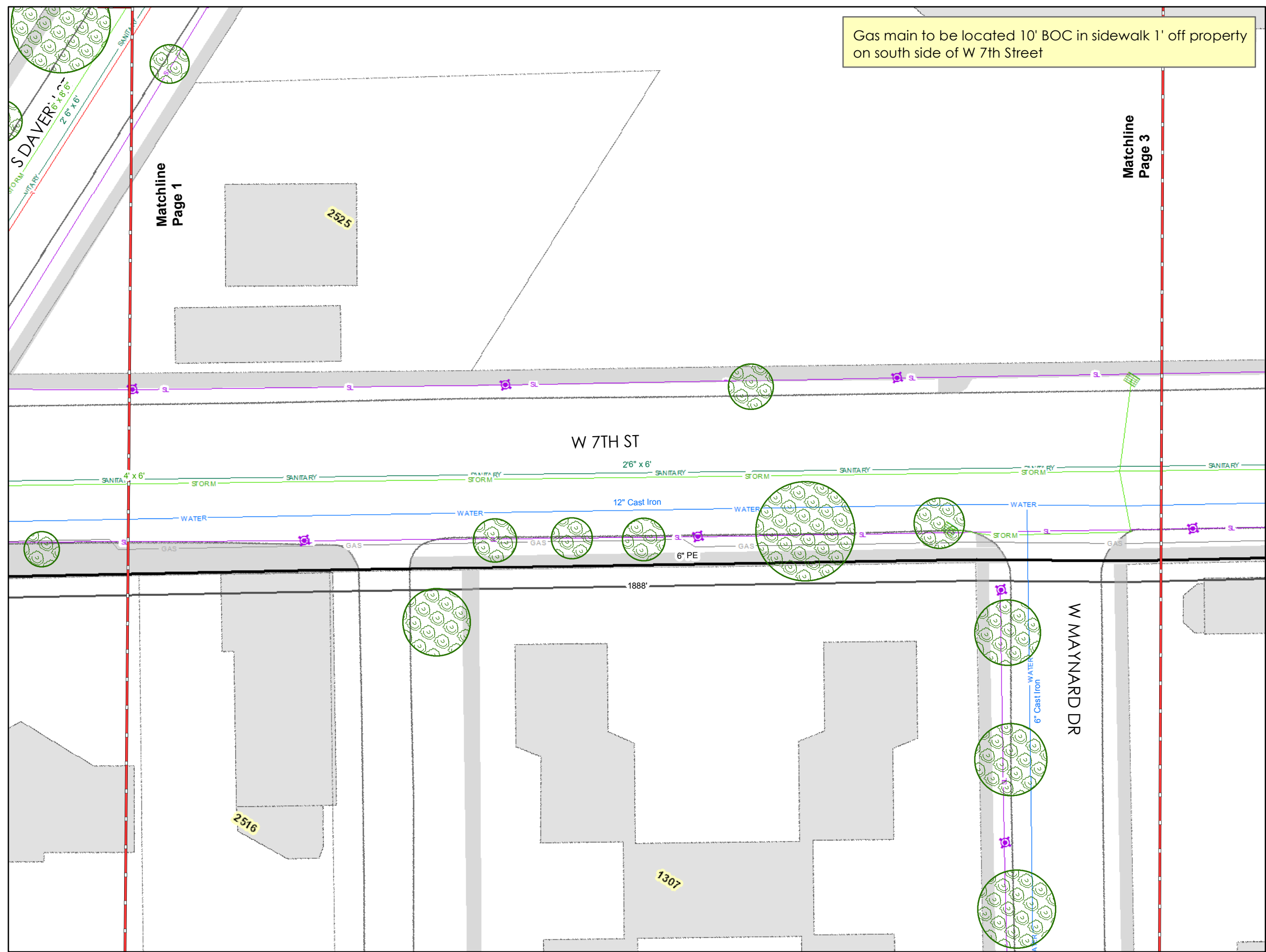

Gas main to be located 10' BOC in sidewalk 1' off property on south side of W 7th Street

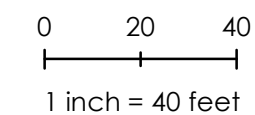

**W 7th St**

Install approx. 2040' of 6" main by directional bore on W 7th St.  
Renew or transfer 6 services.

Design: 559113      Location: W 7th St  
WO: 12480512      City: Saint Paul  
Date: 5/3/2017      T:28N R: 23W S: 21,22

Designer: Jeff McGraw  
Email: jeffrey.s.mcgraw@xcelenergy.com  
Phone: (651) 229-2379

I hereby certify that this plan, specification or report was prepared by me or under my direct supervision and that I am a duly Licensed Professional Engineer under the laws of the State of Minnesota.

Date: \_\_\_\_\_ License: \_\_\_\_\_

- |                     |                       |
|---------------------|-----------------------|
| — New Gas Main      | ■ Building Footprints |
| — Sanitary Sewer    | □ Parcels             |
| — Storm Sewer       | ○ Trees               |
| — Water             | — Sidewalk            |
| — UG Electric       | ⊕ Streetlights        |
| — Retired Gas Main  | ■ Catch Basin         |
| — Existing Gas Main |                       |
| — Streetlighting    |                       |

Page 2 of 5  
Created by: Joel Feik

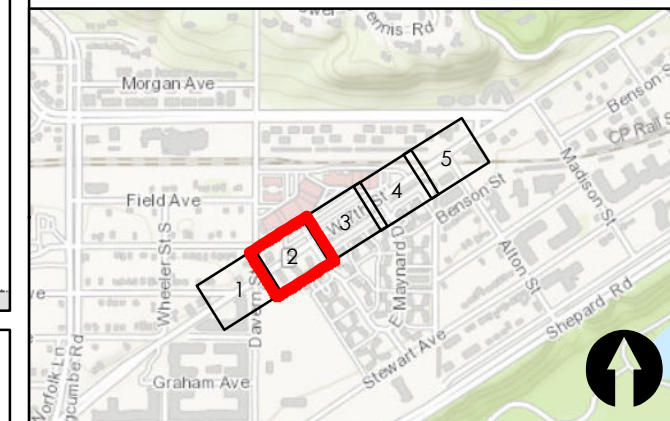

THE SUBSURFACE UTILITY INFORMATION IN THIS PLAN IS UTILITY QUALITY LEVEL D. THIS QUALITY LEVEL WAS DETERMINED ACCORDING TO THE GUIDELINES OF CI/ASCE 38.-2, ENTITLED "STANDARD GUIDELINES FOR THE COLLECTION AND DEPICTION OF EXISTING SUBSURFACE UTILITY DATA".

DISCLAIMER: STATE LAW REQUIRES ANYONE DIGGING, GRADING, OR EXCAVATING TO OBTAIN A PRIOR FIELD LOCATE OF ALL UTILITIES; THIS PRINT DOES NOT DISCHARGE THIS REQUIREMENT OR ANY OTHER REQUIREMENT. BY ACCEPTING THIS PRINT, THE RECIPIENT AND OTHER PARTY RECEIVING A COPY OF THE PRINT ACKNOWLEDGES AND AGREES TO THIS DISCLAIMER. FOR ALL FIELD LOCATES, CALL 811.

Gas main to be located 10' BOC in sidewalk 1' off property on south side of W 7th Street



0 20 40  
1 inch = 40 feet



#### W 7th St

Install approx. 2040' of 6" main by directional bore on W 7th St.  
Renew or transfer 6 services.

Design: 559113 Location: W 7th St  
WO: 12480512 City: Saint Paul  
Date: 5/3/2017 T:28N R: 23W S: 21,22

Designer: Jeff McGraw  
Email: jeffrey.s.mcgraw@xcelenergy.com  
Phone: (651) 229-2379

I hereby certify that this plan, specification or report was prepared by me or under my direct supervision and that I am a duly Licensed Professional Engineer under the laws of the State of Minnesota.

Date: \_\_\_\_\_ License: \_\_\_\_\_

- |                     |                       |
|---------------------|-----------------------|
| — New Gas Main      | ■ Building Footprints |
| — Sanitary Sewer    | □ Parcels             |
| — Storm Sewer       | ○ Trees               |
| — Water             | ● Sidewalk            |
| — UG Electric       | ⊕ Streetlights        |
| — Retired Gas Main  | ■ Catch Basin         |
| — Existing Gas Main |                       |
| — Streetlighting    |                       |

Page 3 of 5  
Created by: Joel Feik

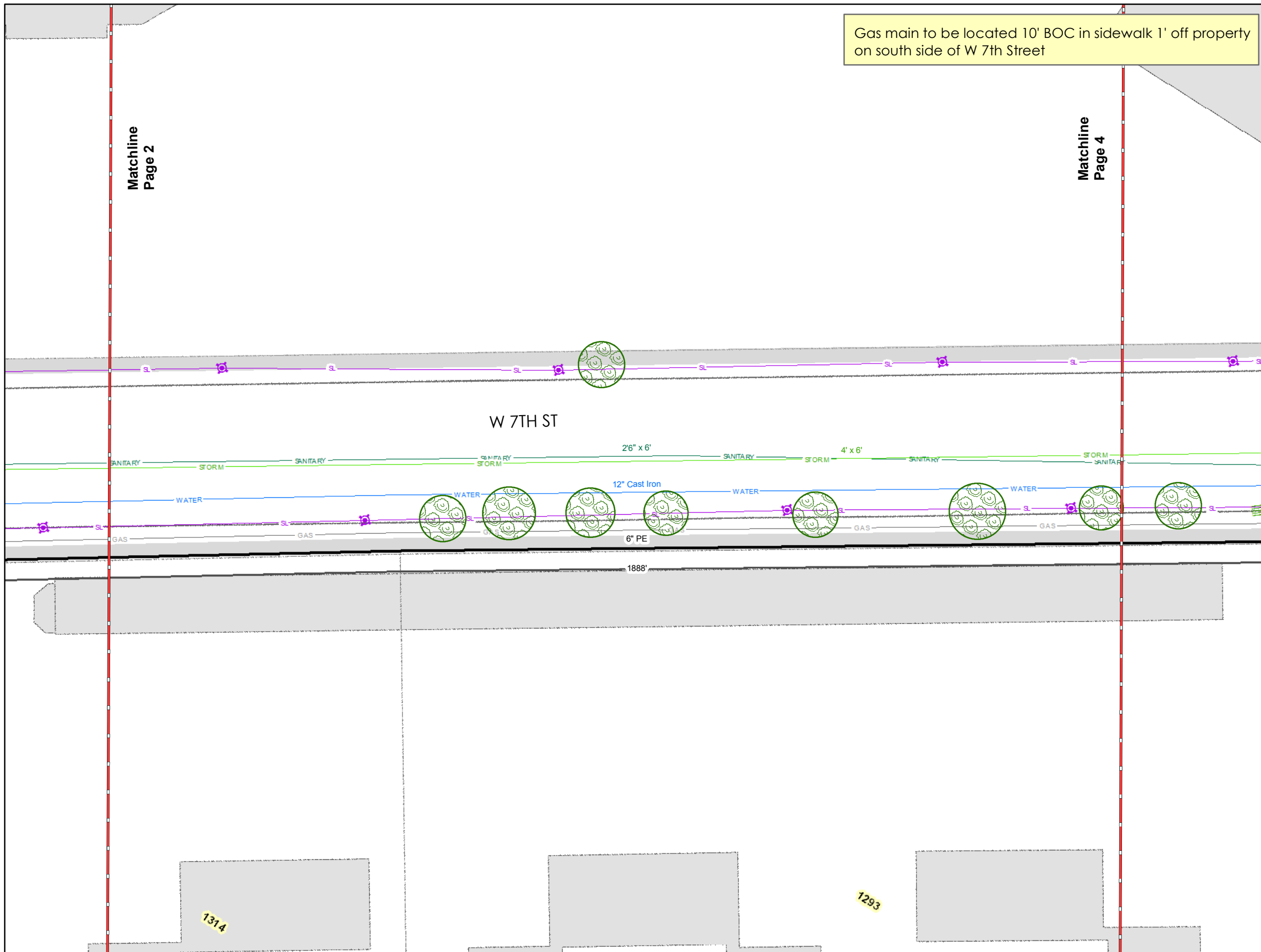
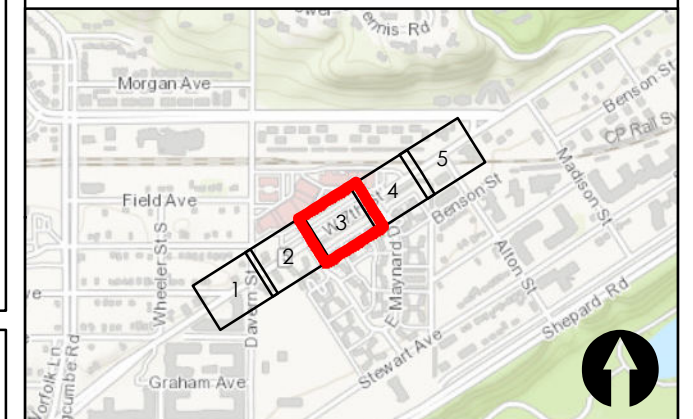

THE SUBSURFACE UTILITY INFORMATION IN THIS PLAN IS UTILITY QUALITY LEVEL D. THIS QUALITY LEVEL WAS DETERMINED ACCORDING TO THE GUIDELINES OF CI/ASCE 38.-2, ENTITLED "STANDARD GUIDELINES FOR THE COLLECTION AND DEPICTION OF EXISTING SUBSURFACE UTILITY DATA".

DISCLAIMER: STATE LAW REQUIRES ANYONE DIGGING, GRADING, OR EXCAVATING TO OBTAIN A PRIOR FIELD LOCATE OF ALL UTILITIES; THIS PRINT DOES NOT DISCHARGE THIS REQUIREMENT OR ANY OTHER REQUIREMENT. BY ACCEPTING THIS PRINT, THE RECIPIENT AND OTHER PARTY RECEIVING A COPY OF THE PRINT ACKNOWLEDGES AND AGREES TO THIS DISCLAIMER. FOR ALL FIELD LOCATES, CALL 811.



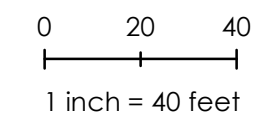
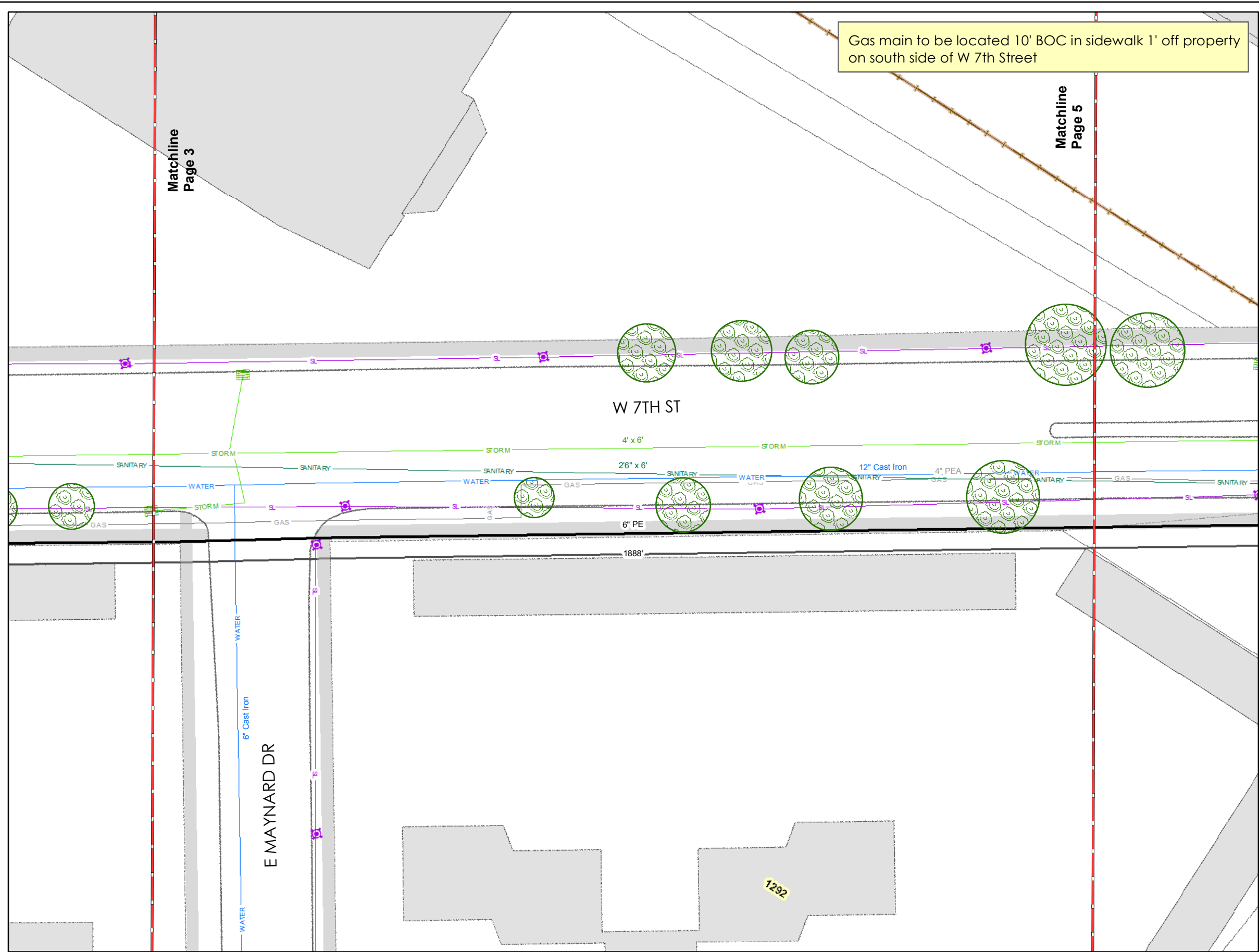

**W 7th St**

Install approx. 2040' of 6" main by directional bore on W 7th St.  
Renew or transfer 6 services.

Design: 559113      Location: W 7th St  
WO: 12480512      City: Saint Paul  
Date: 5/3/2017      T:28N R: 23W S: 21,22

Designer: Jeff McGraw  
Email: jeffrey.s.mcgraw@xcelenergy.com  
Phone: (651) 229-2379

I hereby certify that this plan, specification or report was prepared by me or under my direct supervision and that I am a duly Licensed Professional Engineer under the laws of the State of Minnesota.

Date: \_\_\_\_\_ License: \_\_\_\_\_

- New Gas Main
- Sanitary Sewer
- Storm Sewer
- Water
- UG Electric
- Retired Gas Main
- Existing Gas Main
- Streetlighting
- Building Footprints
- Parcels
- Trees
- Sidewalk
- Streetlights
- Catch Basin

Page 4 of 5  
Created by: Joel Feik

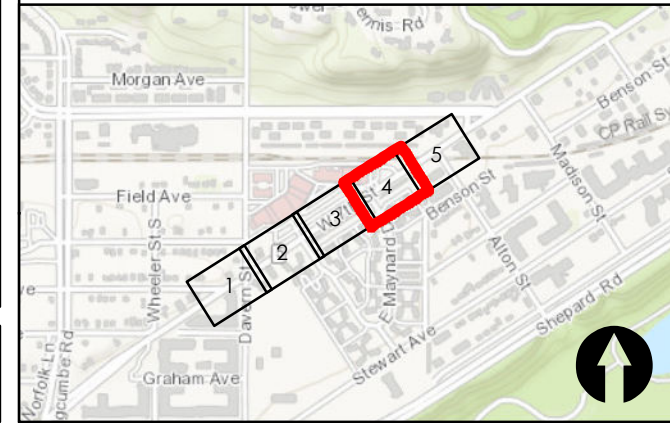

THE SUBSURFACE UTILITY INFORMATION IN THIS PLAN IS UTILITY QUALITY LEVEL D. THIS QUALITY LEVEL WAS DETERMINED ACCORDING TO THE GUIDELINES OF CI/ASCE 38.-2, ENTITLED "STANDARD GUIDELINES FOR THE COLLECTION AND DEPICTION OF EXISTING SUBSURFACE UTILITY DATA".  
DISCLAIMER: STATE LAW REQUIRES ANYONE DIGGING, GRADING, OR EXCAVATING TO OBTAIN A PRIOR FIELD LOCATE OF ALL UTILITIES; THIS PRINT DOES NOT DISCHARGE THIS REQUIREMENT OR ANY OTHER REQUIREMENT. BY ACCEPTING THIS PRINT, THE RECIPIENT AND OTHER PARTY RECEIVING A COPY OF THE PRINT ACKNOWLEDGES AND AGREES TO THIS DISCLAIMER. FOR ALL FIELD LOCATES, CALL 811.

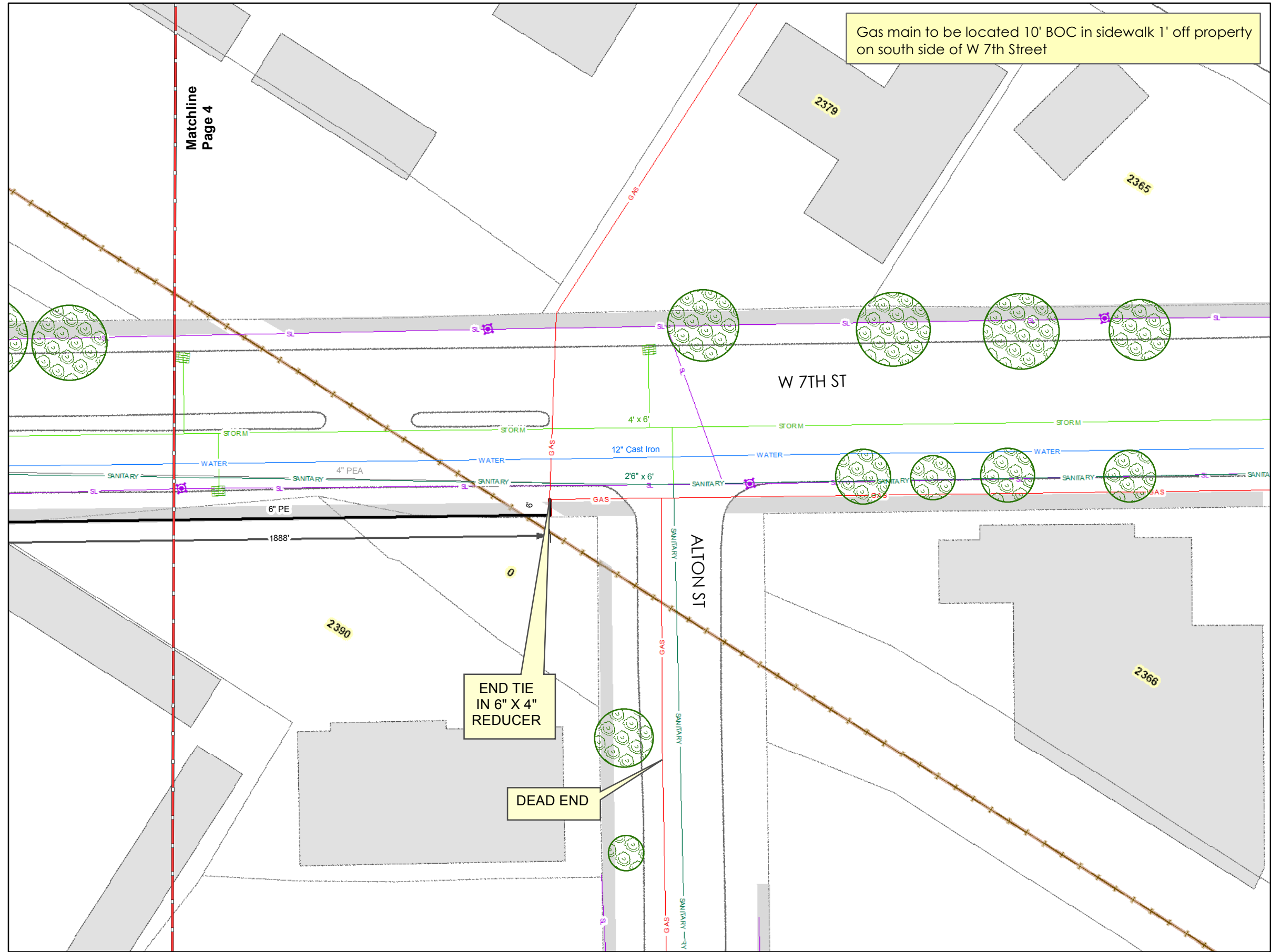

Gas main to be located 10' BOC in sidewalk 1' off property on south side of W 7th Street



02040

1 inch = 40 feet



**W 7th St**  
Install approx. 2040' of 6" main by directional bore on W 7th St.  
Renew or transfer 6 services.

Design: 559113      Location: W 7th St  
WO: 12480512      City: Saint Paul  
Date: 5/3/2017      T:28N R: 23W S: 21,22

Designer: Jeff McGraw  
Email: jeffrey.s.mcgraw@xcelenergy.com  
Phone: (651) 229-2379

I hereby certify that this plan, specification or report was prepared by me or under my direct supervision and that I am a duly Licensed Professional Engineer under the laws of the State of Minnesota.

Date: \_\_\_\_\_ License: \_\_\_\_\_

- |                   |                     |
|-------------------|---------------------|
| New Gas Main      | Building Footprints |
| Sanitary Sewer    | Parcels             |
| Storm Sewer       | Trees               |
| Water             | Sidewalk            |
| UG Electric       | Streetlights        |
| Retired Gas Main  | Catch Basin         |
| Existing Gas Main |                     |
| Streetlighting    |                     |

Page 5 of 5  
Created by: Joel Feik

